

GENERAL INFORMATION

The Registration Desk

The Registration Desk will be open during the conference period. It is located outside the Wei Hing Theatre from 8:30 (from 8:00 on June 16) to 12:00 and outside Room G5215 from 13:30 to 18:30.

Venue

Plenary Talks: Wei Hing Theatre [6/F Academic Building, CityU]

Workshops: Rooms B5211, B5311, G5214, G5215, G5216, G5217, G 5317
[5/F Academic Building Blue Zone and Green Zone]

Poster and Discussion Room

Room G5131 will be open in the afternoons (from 13:50 to 18:30pm) during the workshop period for poster session and discussion (white board, markers and erasers will be available there).

Foreign Currency Exchange

The Hang Seng Bank at CityU will cash your travellers' cheques on production of your passport. They also provide foreign currency exchange services.

Email and Fax Services

Email service are available at the Mathematical Laboratory, Room Y6504 (6/F Academic Building, near Lift No. 9) during the conference period from 9:00 to 18:30pm. Username and password information will be given to you upon registration.

Fax messages can be sent to (852) 2788-8561 (please quote "FOCM'08" and state clearly the names of recipients). Please ask our conference coordinator or assistants for help if you need to send or receive a fax.

Conference Banquet - 22 June 2008 (Sunday)

The banquet will begin from 19:30 p.m. onwards at Spasso Italian Bar & Restaurant

- 1) Buses will depart CityU (from U-Circle) at 18:40 p.m
- 2) Cost: HK\$400 per person (Prior registration is required.)

Catering

Several food outlets are available on CityU campus and over 30 restaurants can be found at the adjacent shopping mall Festival Walk.

CityU Campus

City Express (Student Canteen), 5/F, Amenities Building Operated by the Maxim fast-food chain, City Express is the largest food outlet at CityU. It is the place where most students and staff go for food. It offers breakfast, lunch, afternoon-tea, dinner and snacks. Both western-style and Asian-style foods are available.

City Chinese Restaurant, 8/F, Amenities Building This restaurant serves typical Chinese cuisine, Cantonese Dim Sum, and dishes of the style of northern China.

City Top, 9/F, Amenities Building Mostly western cuisine is served in this restaurant. Several formulas are available including la carte, set menus, and a salad bar buffet.

Garden Café, G/F, Academic Exchange Building The prices are slightly higher than those at the City Express (Student Canteen), but it attracts both staff and students with an outdoor seating area in a quiet surrounding.

Homey Kitchen, Student Residence at Cornwall Street If you live in the Student Residence at Cornwall Street, you will find this small co-op shop with a seating area. The shop provides light meals, snacks, drinks and daily necessities.

Festival Walk

With an extensive selection of restaurants and price ranges, the adjacent shopping mall provides more catering choices.

六樓 Floor 6

Wei Hing Theatre
Amenities Building
Lift 13, Floor 6

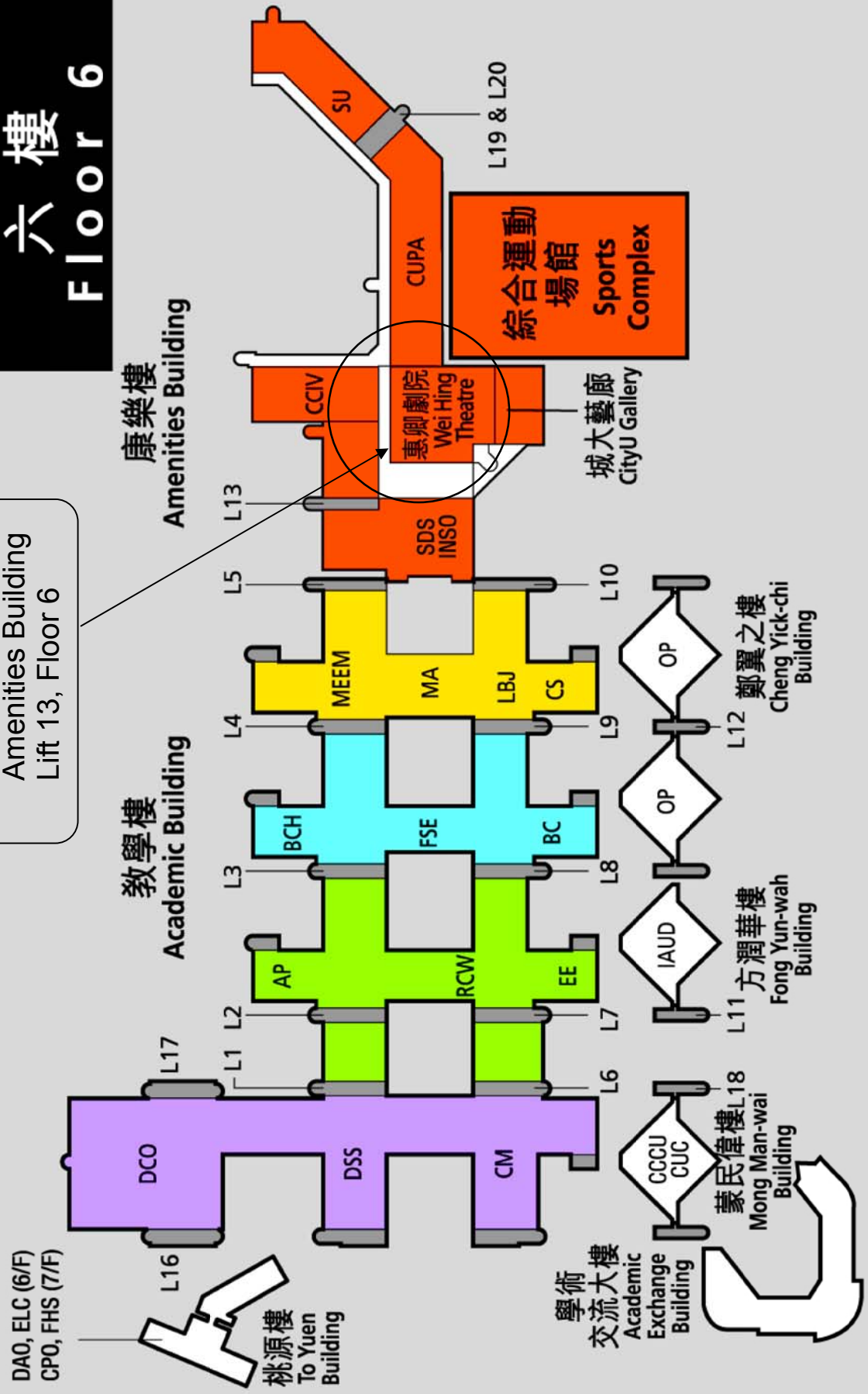

Plan of the 5th Floor

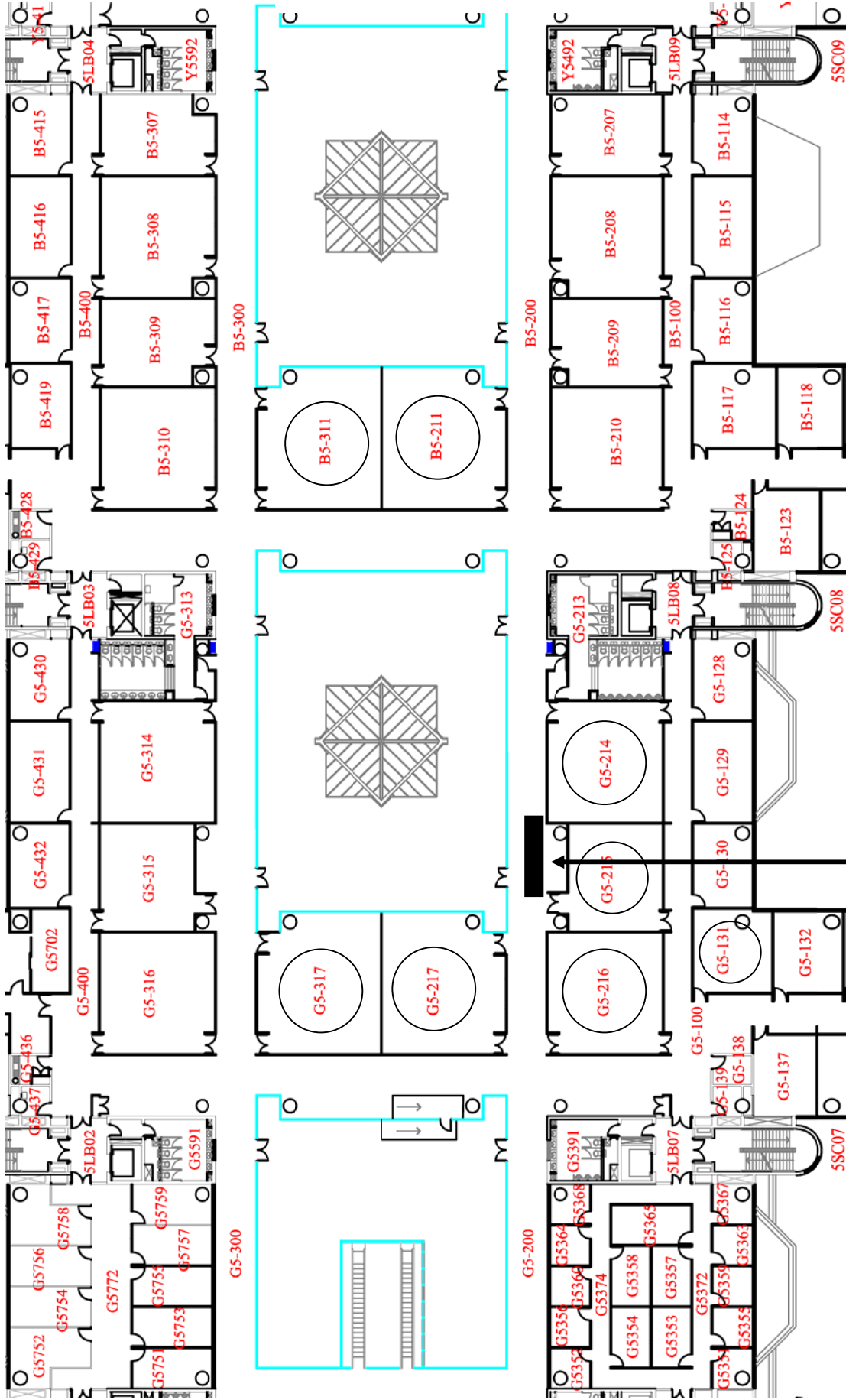

Registration Desk