

NOTE: GOUGH WAY FLOOD DEFENCES REQUIRED FOR OPTIONS 3 AND 4 ONLY.

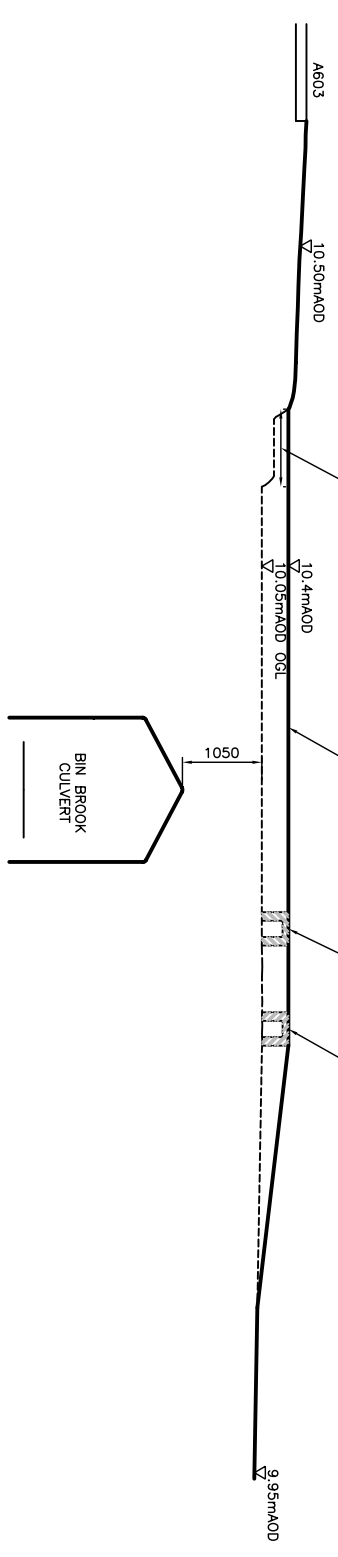
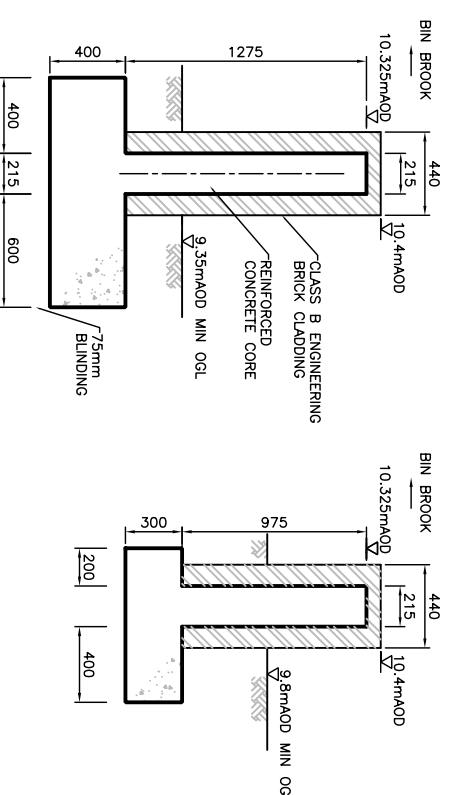
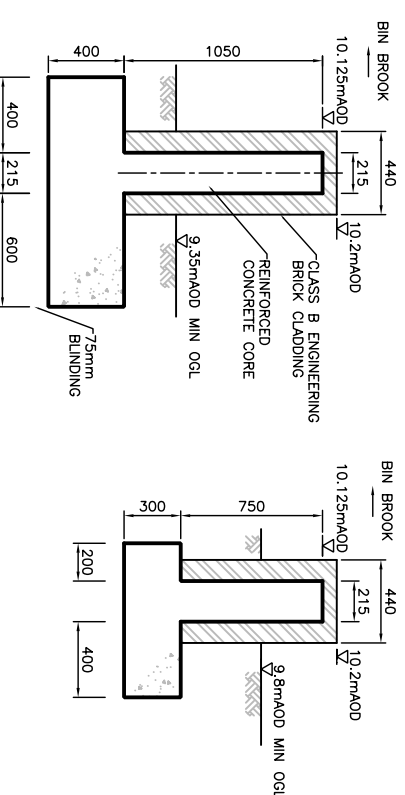
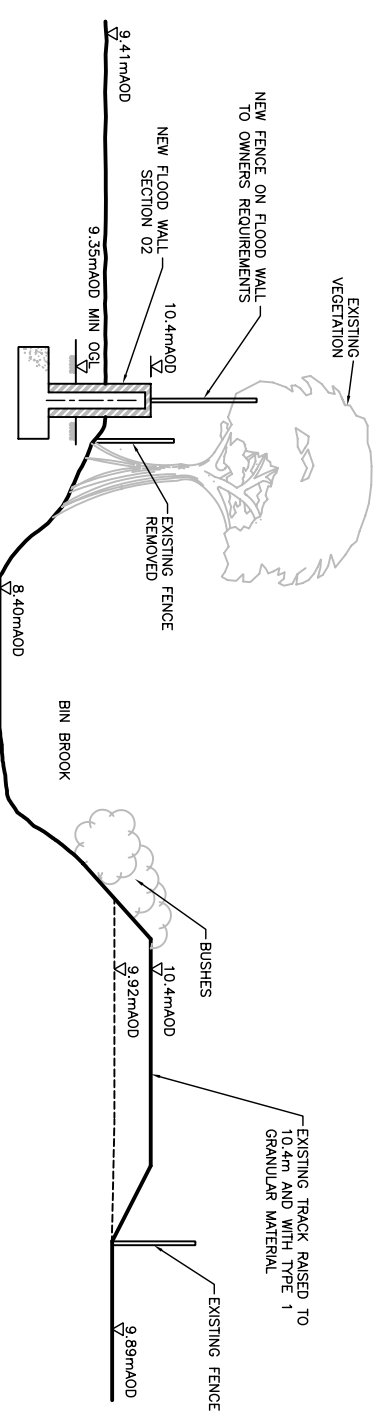
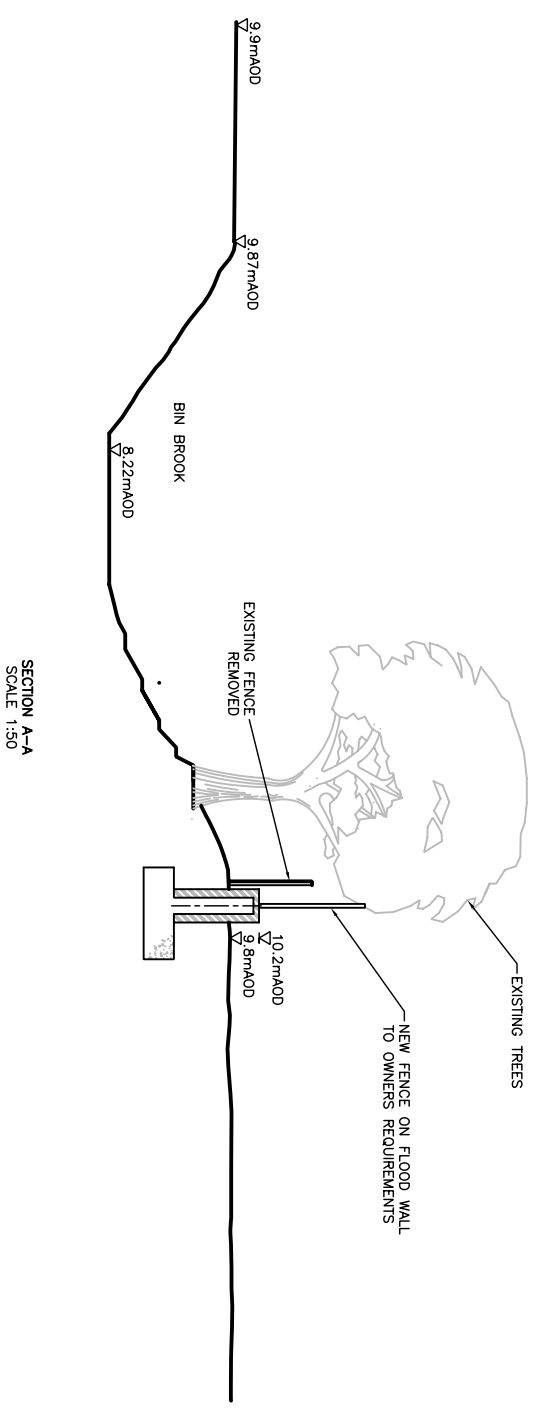

- NOTES:
1. DO NOT SCALE FROM THIS DRAWING.
 2. ALL DIMENSIONS IN MILLIMETERS UNLESS OTHERWISE SPECIFIED.
 3. ALL LEVELS IN METERS ABOVE ORDNANCE DATUM

Revision	By	Checked/Approved	Date	Description
E				
D				
C				
B				
A				

Client: Environment Agency
 Environment Agency
 Engineering House
 3rd Floor
 Centenary Way
 Peterborough, PE2 5ZB
 Tel: 01753 231940
 Fax: 01753 231940

Halcrow Group Limited
 Engineer: Helen, Optimal Inst., Harlow, Essex, UK
 Tel: 01753 500033 Fax: 01753 427988
 www.halcrow.com

Halcrow

Project: **BIN BROOK FLOOD ALEVIATION**

Drawing: **GOUGH WAY FLOOD DEFENCES CROSS SECTIONS.**

Drawn By: LJC Date: NOV 2006
 Checked By: Date:
 Authorised By: Date:
 Drawing No: **WNBINP-006** Revision: **0**
 Drawing Scale: As Shown
 CAD Filename: WNBINP-006.dwg Plot Scale: 1:1